

Alpha Machine Lay

Laying Pattern

Alpha Antique Machine Lay Clusters

Brett Alpha Antique is available in a prearranged stretcher course machine lay formation pack in both 60 and 80mm. Alternate rows will require side shifting during the installation.

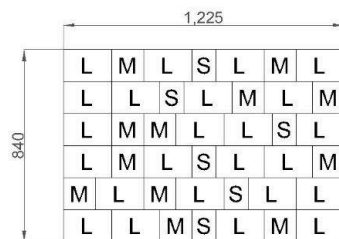

42 block cluster formation, as viewed by the machine lay operative.

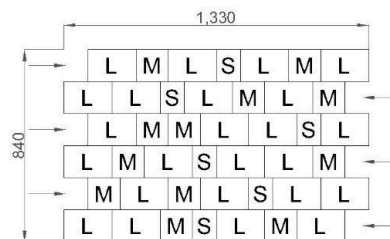

Alternate rows side shifted by 105mm during the installation.

Stage.1. – First Cluster in the correct position

- Select datum, usually the longest length.
- Install Cluster 1 with the left hand side of the cluster on the datum.
- Infill the gaps with the Small Blocks (105x140mm).
- Install additional clusters as shown.

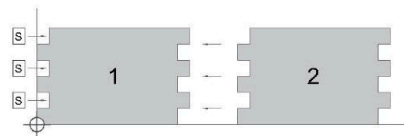

Stage.2. – Offsetting the second row

- The second row of clusters requires offsetting to prevent vertical lines running up through the bond.
- Place Medium Blocks (140x140mm) & Small Blocks (105x140mm) against the datum as shown.
- Then install adjacent clusters.

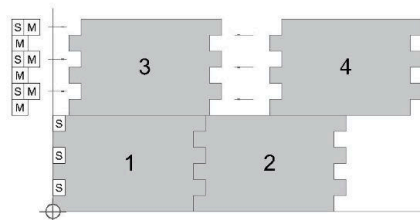

Stage.3. – Continuation

- Repeat Stages 1 & 2 against the datum.

Additional Information

- For significantly large areas machine lay packs will be identified with a unique ascending number sequence. It is recommended that packs are installed in the same numerical order.
- Picking up the cluster must always be undertaken from the side of the pack with the two large blocks in the bottom left hand corner of the cluster.

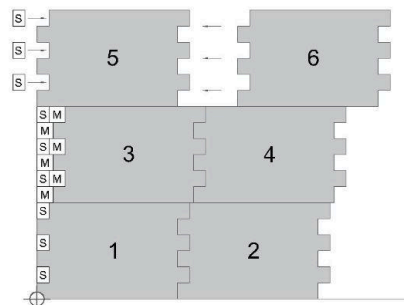

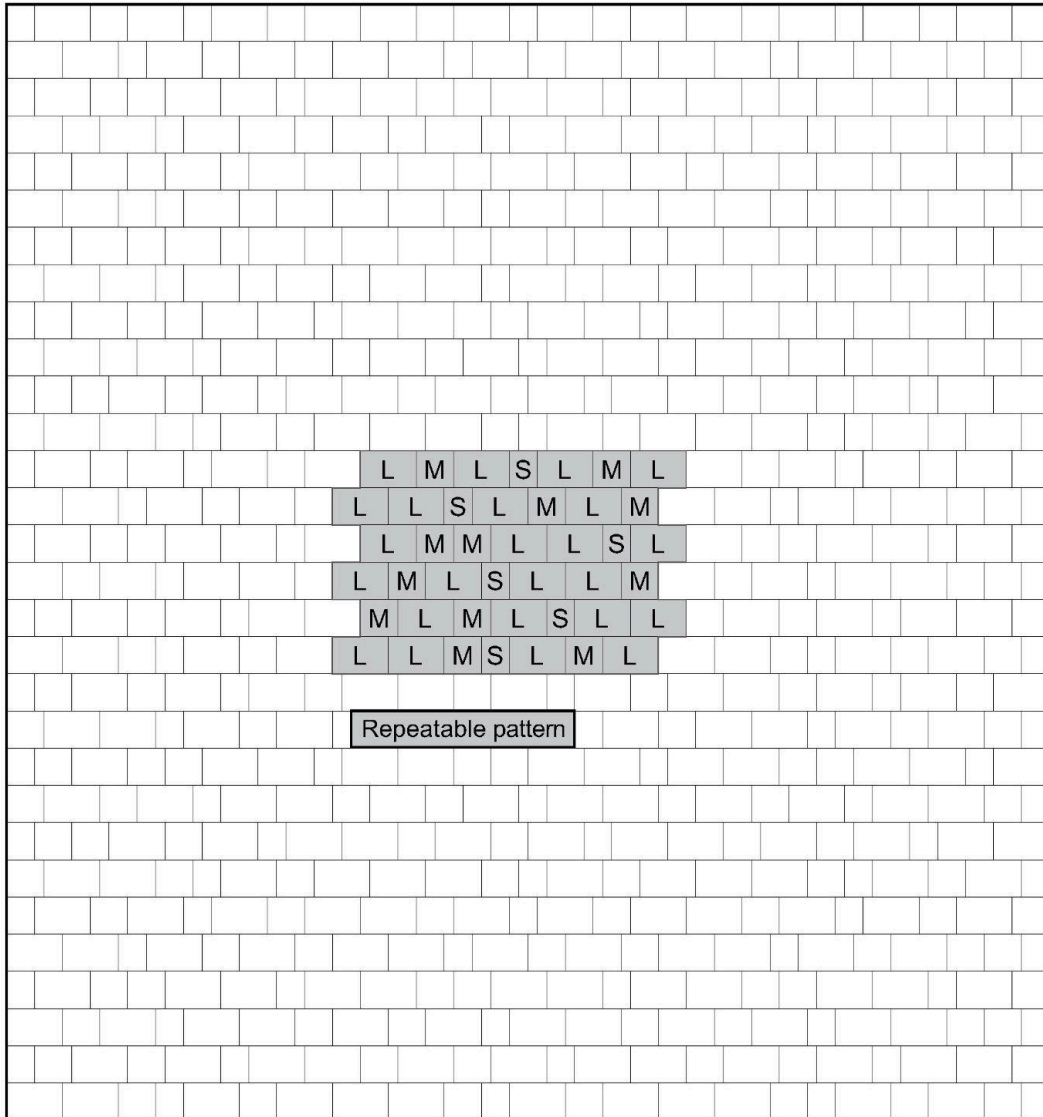

Pattern AML.01 - Stretcher Bond - P & L*

6 No. - (S) 105x140mm per repeat 12 No. - (M) 140x140mm per repeat

24 No. - (L) 210x140mm per repeat

Traffic categories - Pedestrian only (P) & Light duty inc driveways (L) - * Subject to direction of traffic